

4008 Series

Mini Din Jack Stack Type

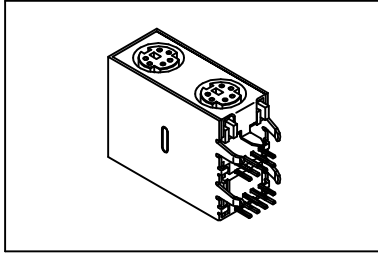

Material:

Housing: 15% Glass filled PBT UL94V-0.
 Contacts: Phosphor Bronze, Tin Plated.
 Panel Gnd: Stainless, Nickel Plated.

Electrical Characteristics:

Contact Resistance: 30mΩmax.
 Insulation Resistance: 100MΩAT 500V DC.
 Rating: DC 12V, 1.0A max.
 Dielectric Withstanding Voltage: 500V AC(RMS) applied between adjacent open terminals for 1 minute without breakdown.
 Operating Temperature: -55°C ~ +105°C.
 Insertion Force: 0.5~4.5Kg.
 Withdrawal Force: 0.4~3.5Kg.
 Durability Test: 5000 mating cycles min.

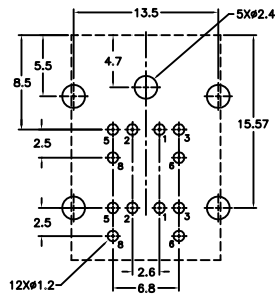
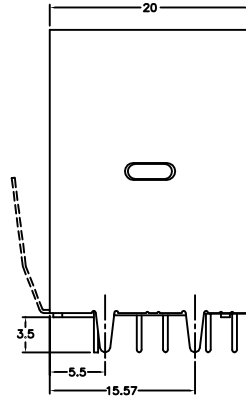
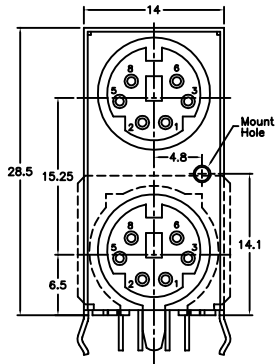

P.C. Board Layout
(Top View)

Ordering information

4008- X A A
 Series Position 4, 6, 8 A: With spring A: 15.57mm
 B: W/O Spring and W/O mount hole
 C: W/O Spring and with mount hole

* Standard Color Black, Available Green on Upside and Under is Purple.